

ITEM SKU#: 662187485485

# Sigma Gen2

## T8 Emergency Tube Type B

COMMERCIAL LIGHTING | LED TUBES



### FEATURES

- The standard input end powers the lamp under normal hours, while the emergency input end both charges the batteries and detects the availability of AC power.
- Emergency and standard fluorescent ballasts can be removed.
- Incorporates a charging light indicator.
- MCU system with a self-test function, meaning it can test itself on a monthly or yearly basis.
- Unique design with a perfectly uniform visual appearance makes it an easy replacement for existing tube lights.

### APPLICATIONS

Offices, Schools, Hospitals, Retail Stores, Lobbies, General Areas, Residential Spaces

### PRODUCT DETAILS

#### ELECTRICAL

Power	15 W
Voltage	120-277 V
Current	0.06 A
Power Factor	0.9
Total Harmonic Distortion (THD)	10%

#### LIGHTING PERFORMANCE

Lumens	2200 lm
Efficacy	146.7 lm/W
Color Temperature (Selectable)	3500 K-4000 K-5000 K
Color Rendering (CRI)	80
R9 (Red Value)	4
R13 (Skin Tones)	83-86-86
Beam Angle	137°
Dimmable Lighting Control	Continuous Dimming to 10% or Below

#### EMERGENCY BACKUP

Emergency Power	2.5 W
Emergency Lumens	380 lm
Time	90 Minutes
Lithium Battery	9.6 V, 600 mAh Lithium

#### ENVIRONMENT

Operating Temperature	-32 °F ~ +104 °F
Storage Temperature	-4 °F ~ +86 °F
Relative Humidity	45% - 85%
Suitable Location	<b>DAMP</b>

#### LIFESPAN

Average Life (Hours)	50,000
Warranty (Years)	<b>5</b>

#### COMPONENTS

LED Light Source	Seoul, STW8A12D-D1-VN
Driver	Internal Driver/Line Voltage (UL Type B) Lamps

#### CONSTRUCTION

Housing	Oval Extruded Aluminum
Cover Material	Polycarbonate
Diffuser	Frosted
Base	G13
Finish	White

#### PART NUMBER & QUALIFICATIONS

Ordering Part Number	IK-T804-0015(EM)1-CCTB
Qualified Part Number	IK-T804-0015(EM)1-CCTB
SKU Number	662187485485



Not all product variations listed on this page are DLC qualified. Visit <https://www.designlights.org/qpl> to confirm qualification.

## DIMENSIONS AND WEIGHT

Length (Inches)	48.00"
Diameter (Inches)	1.18"
Pin Height (Inches)	0.50"
Net Weight (lbs)	1.19

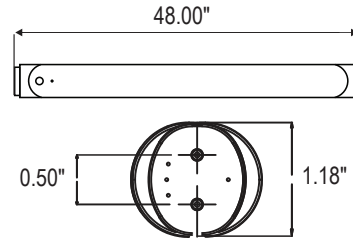

## PACKAGING

Box Dimensions (Inches)	51.57" x 8.07" x 8.85"
Box Weight (lbs)	29.76
Quantity Per Box	25

## SUPPORTING DOCUMENTS

DOCUMENTS	DOCUMENT LINK
<a href="#">Product Sheet</a>	<a href="#">View / Download</a>
<a href="#">IES Files</a>	<a href="#">View / Download</a>
<a href="#">LM79 Report</a>	<a href="#">View / Download</a>
<a href="#">LM80 Report</a>	<a href="#">View / Download</a>
<a href="#">Installation Instructions</a>	<a href="#">View / Download</a>

## ORDERING INFORMATION

SKU NUMBER	DESCRIPTION	QUANTITY/BOX
662187485485	SIGMA GEN2 T8 EM TUBE TYPE B: 4FT / 15 W / 2200 LM / 35-40-50 K / 120-277 V / WHITE	25